

Model: PLD-MO96

Glass Pendant System Socket

WAC LIGHTING
Responsible Lighting®

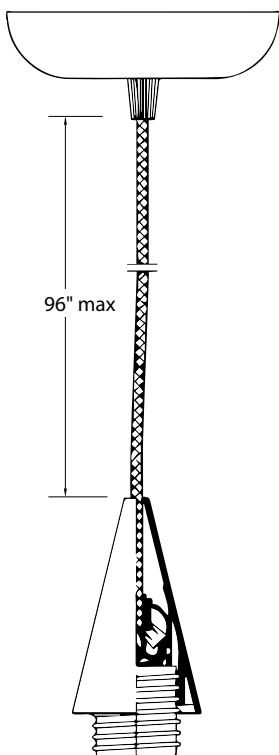

Fixture Type:

Catalog Number:

Project:

Location:

PRODUCT DESCRIPTION

Compact Fluorescent (CFL) pendant socket for use with selected shades. Designed for flat ceilings.

FEATURES

- 96" socket set with 4 1/2" canopy
- Uses A19 / G30 lamp
- Glass shade is ordered as a separate line item and installed in the field
- 8' long socket set cable allows easy filed cutting to desired drop length
- 5 year WAC product warranty

ORDER NUMBER

Model #	Finish
PLD-MO96	BK Black
	BN Brushed Nickel
	WT White

PLD-MO96 -

Example: **PLD-MO96-BK**

SPECIFICATIONS

Lamp: Uses one A or G30 Lamp, 100W max. Order lamp separately.

Materials: Plated steel canopy. Die-cast aluminum and plated socket housing. Three pin supports may be detached to allow additional shade styles.

Standards: UL and CUL Listed.

WAC Lighting
www.waclighting.com
Phone (800) 526.2588 • Fax (800) 526.2585

Headquarters/Eastern Distribution Center
44 Harbor Park Drive • Port Washington, NY 11050
Phone (516) 515.5000 • Fax (516) 515.5050

Western Distribution Center
1750 Archibald Avenue • Ontario, CA 91760
Phone (800) 526.2588 • Fax (800) 526.2585

INSTRUCTIONS: PLD Models Pendant Shade Installation

CAUTION

- Always turn off power at main switch prior to installation to prevent electrical shock.

SINGLE PIECE SHADE:

All components screw clockwise to tighten.

1. Make certain the Nord style socket is screwed fully into the aluminum cone.
2. Note the orientation of the black threaded retaining ring in the diagram.
3. Raise the shade to the level of the Nord socket so that the threaded portion protrudes through the hole.
4. Place the leveling spring on top of the retaining ring, and screw on to the socket until the shade is snug against the aluminum cone.

LAMPING:

Single piece shades accept "A" or "G" type lamps 100 Watt max.

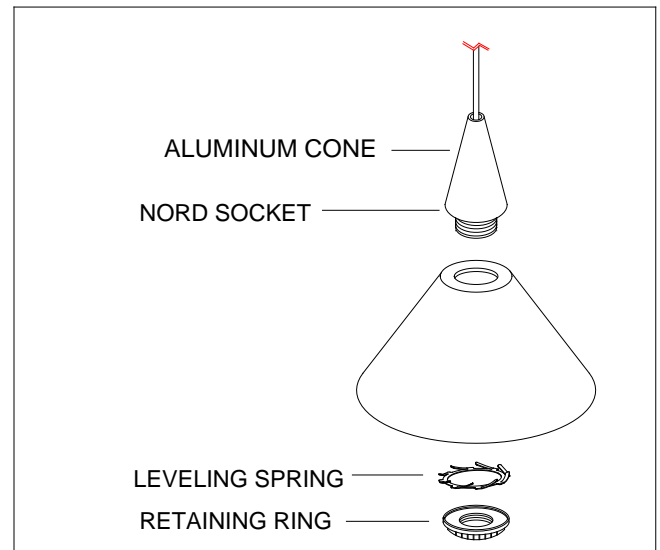

TWO PIECE SHADES:

All components screw clockwise to tighten.

1. Make certain the Nord style socket is screwed fully into the aluminum cone.
2. The longer aluminum ring retains the outer shade and the short aluminum ring retains the inner shade.
3. Raise the outer shade to the level of the Nord socket so that the threaded portion protrudes through the hole. Place the leveling spring on top of the long retaining ring and screw on the socket until the shade is snug against the aluminum cone.
4. Install one plastic washer between the inner shade and long ring. Install the second plastic washer between the short retaining ring and shade.
5. Secure the inner shade by screwing the short retaining ring onto the threads of the long ring.

LAMPING:

Double glass shades accept "A" lamps only, 100 Watt max.

