



EXHAUST FAN NOTE:

- * ENERGY STAR <1 SONE W/ SMOOTH 4" DUCTING INSULATED TO R-11 IN UNCONDITIONED SPACES.
- * INSTALL TIMERS, HUMIDISTAT, OR OCCUPANCY SENSORS FOR BATH AND LAUNDRY FANS.

PLUMBING NOTE:

ALL SHOWERHEADS & KITCHEN SINK FAUCETS IN STALLED IN THE HOUSE SHALL BE RATED AT 1.75 GPM OR LESS. ALL OTHER LAVATORY FAUCETS SHALL BE RATED AT 1.0 GPM OR LESS.



COMBO CARBON MONOXIDE & SMOKE ALARM
R315 & R314

R314.2.3 New attached garages. A heat detector or heat alarm rated for the ambient outdoor temperatures and humidity shall be installed in new garages that are attached to or located under new and existing dwellings. Heat detectors and heat alarms shall be installed in a central location and in accordance with the manufacturer's instructions.

GARAGE/DWELLING SEPARATION: 2018 IRC Section R302.6

The garage shall be separated from the residence and its attic area by not less than 1/2" gypsum board applied to the garage side. Garages beneath habitable rooms shall be separated from all habitable rooms above by not less than 5/8" Type X gypsum board. Structural members supporting the horizontal separation shall be protected by minimum 1/2" gypsum (this includes all bearing walls, posts, columns, etc.).

GARAGE/DWELLING DOOR: 2018 IRC Section R302.5

Openings from a private garage directly into a room used for sleeping purposes shall not be permitted. Other openings between the garage and residence shall be equipped with solid wood doors not less than 1-3/8 inches in thickness, solid or honeycomb core steel doors not less than 1-3/8 inches thick, or 20-minute fire-rated doors and must include a self-closing device.

R302.5.1

Garage door to house is weatherstripped. (WSEC 502.4.2)

- NOTES:
1. REF. IRC R305=1 SF PER 150 SF OF VENTILATED AREA.
 2. VENT SHALL BE COVERED W/ 1/8" GAL. SOFFIT SCREEN. TYP. VENT AREA CALC. @ 75% EFFICIENCY.
 3. GABLE VENTS INSTALLED 3" ABOVE EAVES.

CALCULATIONS

Req. Ventilation 1322 SF @ 8.1 SF X 144 SF=1269 SI
150 2 = 634 SI INTAKE- EAVE
634 SI EXHAUST-RIDGE

RIDGE VENT 38 LF @ 17 SI PLF = 646 SI TOTAL EXHAUST 646 SI
BIRD BLOCKS 44 EA. @ 14.73 SI=646 SI TOTAL INTAKE 648 SI

NET VENTILATION AREA OF VENTS

TYP. EAVE VENT (Bird Block) W/(3) 2 1/2" HOLES: NET FREE AREA= 14.73 SI,
TYP. CONT. RIDGE VENT COR-A-VENT V4000: NET FREE AREA=17 SI per LF
SMART VENT in place of vented blocks: NET FREE AREA=16 SI per LF

GABLE VENTS: 12"X18"=432 SI X.75= 162 SI
18"X24"=432 SI X.75= 324 SI

ATTIC SPACE VENTILATION ELEV.

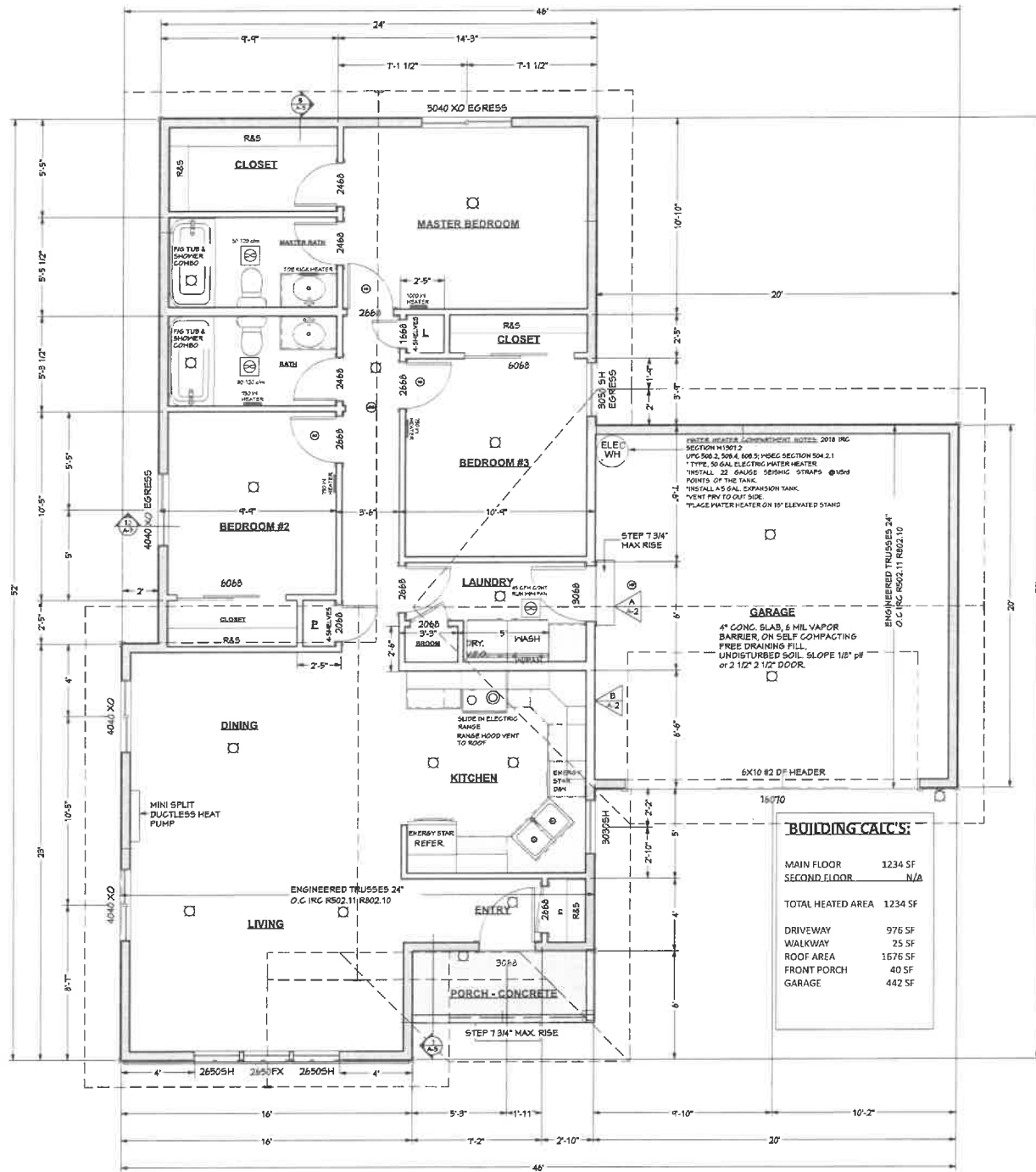

FLOOR PLAN
SCALE: 1/4"=1'-0" 1234 SF

A-2

of SIX

HOUSING KITSAP
2244 NW Bucklin Hill Road
Silverdale, WA 98383
Tel: 360-535-6100
Toll-Free: 1-800-693-7070
Fax: 360-535-6169
TDD/TTY: 360-535-6106
HousingKitsap@housingkitsap.or



REVISION	DATE	BY
CONC. SLAB	7.29.2022	BK
COUNTY CORRECTIONS	1.28.23	BK

HOUSING KITSAP
1234 sf Ranch 3-BdRm, 2-Bath,
2-Car-R

PERMIT SET

BUILDING CALC'S:

MAIN FLOOR 1234 SF
SECOND FLOOR N/A

TOTAL HEATED AREA 1234 SF

DRIVEWAY 976 SF
WALKWAY 25 SF
ROOF AREA 1676 SF
FRONT PORCH 40 SF
GARAGE 442 SF