



EQUINOX™

LUMINA



VISIT OUR WEBSITE



LUMINA

RUBY SERIES

This modern and urban design is perfect for any space, whether it's a contemporary or a chic poolside area. The linear pattern adds a touch of modernity, while the edgy style sets it apart from traditional pools.

Dive into the cool waters and escape the summer heat with the **LUMINA**, the perfect centerpiece for endless hours of relaxation and fun.

Carvin® distinguishes itself by being the only above-ground pool manufacturer to certify every pool with ICC-ES. Designed to comply with ANSI/PHTA/ICC-4 standards.

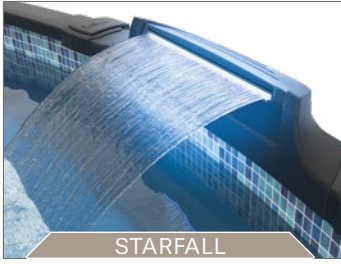

EQUINOX™

BY CARVIN®

POOL FEATURES

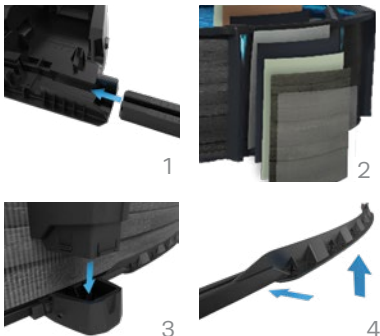

1. Graduated Rails
2. Pool Wall Protection
3. Snap In Uprights
4. Stable and High Wall Rails

SPECIFICATIONS

Height - 52" Steel
54" Aluminum
Ledges - 7.5"
Uprights - 8"

POOL DIMENSIONS

ROUND

12', 15', 18', 21', 24', 27', 30', 33'

OVAL

12' x 15', 12' x 18', 12' x 21', 12' x 24'
15' x 21', 15' x 24', 15' x 30'
18' x 33', 18' x 39'