

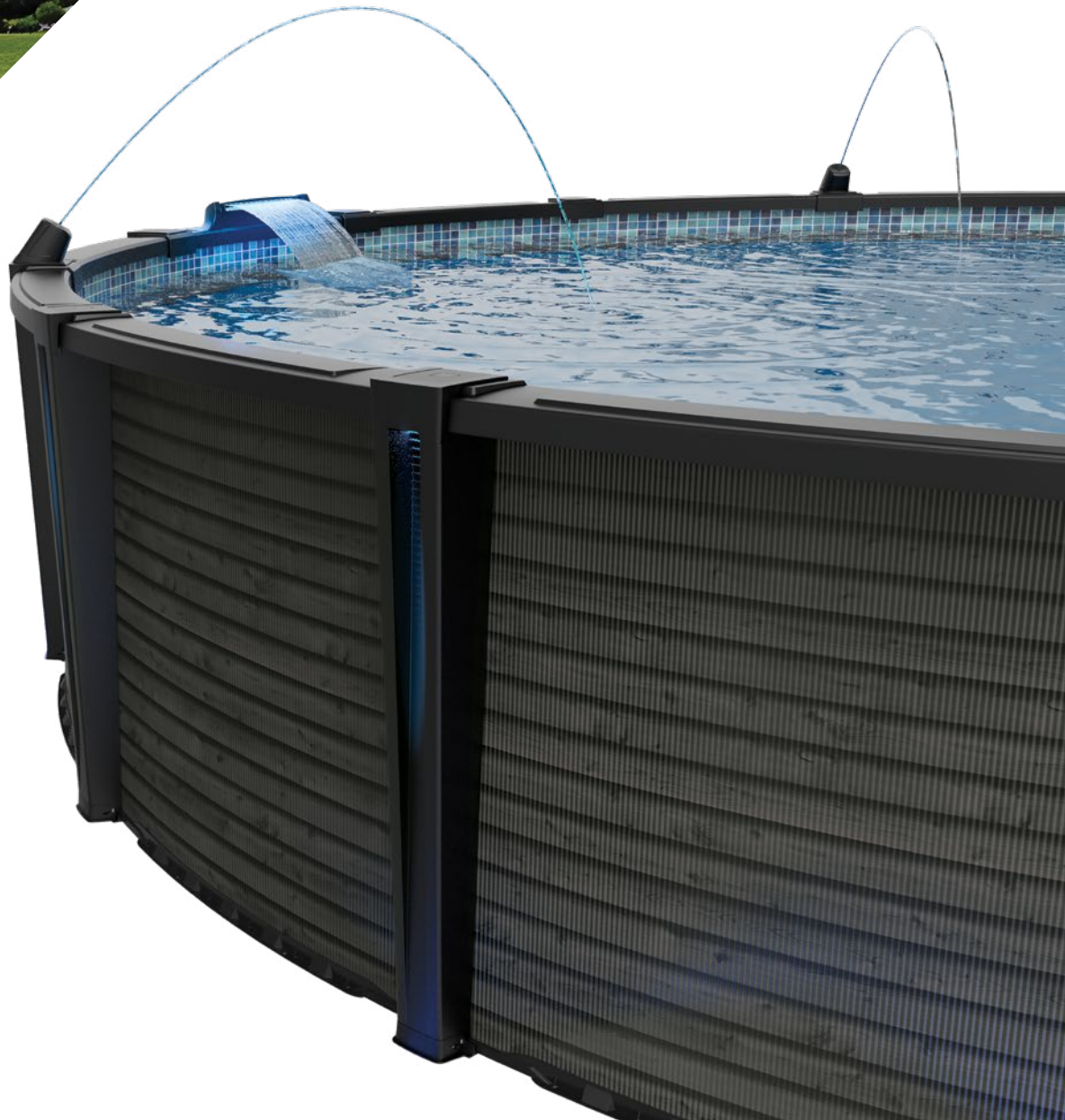

EQUINOX™ POMPEII



VISIT OUR WEBSITE



POMPEII

RUBY SERIES

Bold, architectural, and built to impress. The **POMPEII** pairs strength and sophistication with commanding visual appeal. Its deep-toned horizontal paneling and modern proportions evokes the enduring presence of its namesake, while the overall design speaks with quiet authority. Pompeii isn't just a pool, it's a statement piece. One that feels as grounded as it looks refined

Carvin® distinguishes itself by being the only above-ground pool manufacturer to certify every pool with ICC-ES. Designed to comply with ANSI/PHTA/ICC- 4 standards.

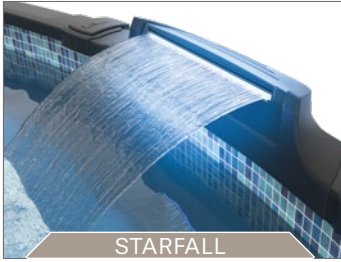

STARFALL



STARGLOW



STARJET



STARBRIGHT



EQUINOX™

BY CARVIN®

POOL FEATURES

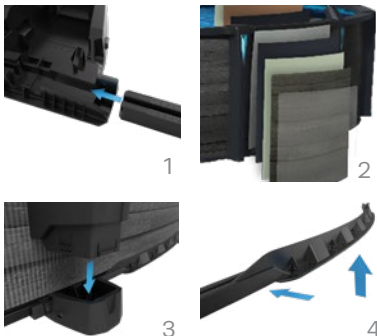

1. Graduated Rails
2. Pool Wall Protection
3. Snap In Uprights
4. Stable and High Wall Rails

SPECIFICATIONS

Height - 52" Steel
54" Aluminum
Ledges - 7.5"
Uprights - 8"

POOL DIMENSIONS

ROUND

12', 15', 18', 21', 24', 27', 30', 33'

OVAL

12' x 15', 12' x 18', 12' x 21', 12' x 24'
15' x 21', 15' x 24', 15' x 30'
18' x 33', 18' x 39'