

REEL TECHNOLOGY

AIR • WATER • OILS • GREASE • ELECTRICAL • GASES
STATIC DISCHARGE • WELDING • EXHAUST • CHEMICALS

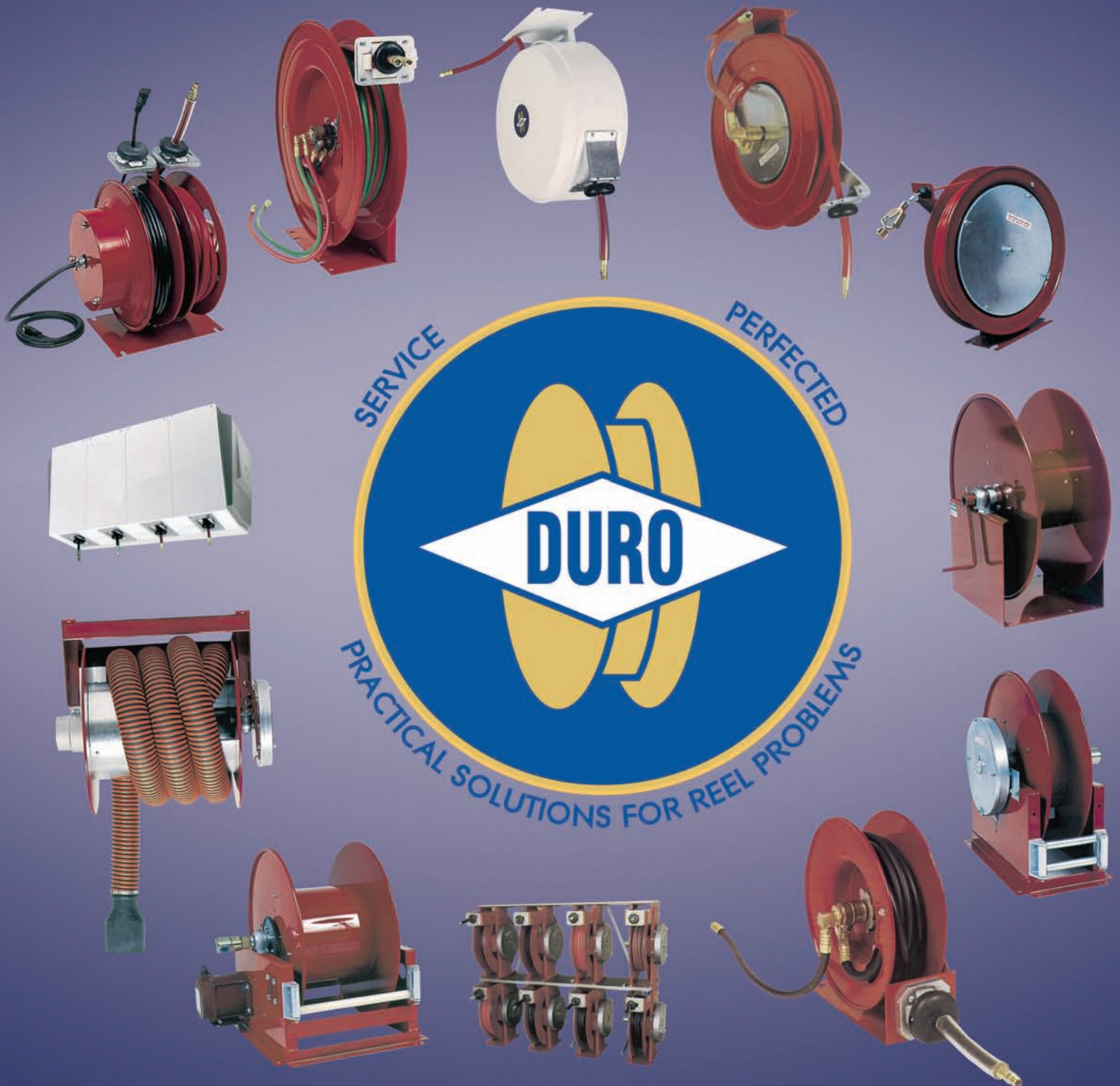

Quality • Efficient • Durable • Versatile • Economical • Reliable

DURO REELS

AUTOMOTIVE & INDUSTRIAL SERVICE PERFECTED

(SINCE 1968)



MAIN OFFICE

3505 Arrowhead Drive • Carson City, Nevada 89706
(775) 687-8866 • FAX: (775) 687-8877
www.durohosereels.com



ASSEMBLY

DESIGN SIMPLICITY

Duro Reels outstanding designs and built in flexibility saves you time and money. The versatility that you get from Duro Reels is worthy of consideration. They can be relied upon to give you the ultimate in service without maintenance and costly down time.

- CONSTRUCTION:** All materials are of the finest grade, powder coat and other conversion coatings used on parts before assembly. Cast aluminum, bronze, brass, nylon and steel combats rust factor.
- FULL FLOW SWIVEL JOINTS:** Precision machined to close tolerance's for assurance of a perfect seal. Attaches to reel as a complete unit and is independent of other moving parts. Standard swivel will handle most gases and liquids.
- BALANCED POWER:** Cartridge type motor springs are reversible for opposite rotation. Spring is centrifugally aligned around axis for smoother action. Easy job site replacements. Designed for minimized breakage.
- HOSE STORAGE:** Heavy gauge steel and aluminum reel spools with rolled edges. Spools rotate on large self-lubricating bearings.
- HOSE CONTROL:** Positive locking with a non sparking ratchet pawl holds hose out at any extended length for tension free use.
- HOSE PROTECTION:** Nylon hose rollers provide smooth quiet action while extending the life of the hose. Hose guide arms adjust to the proper working angle with a one nut adjustment. Guide arms are made of cast heat treated aluminum.
- ELECTRIC POWER REELS:** Industrial duty rubbing contact blocks, high amp systems for greater longevity.
- EFFICIENCY:** More efficiency in high production shops. Improves hose handling by taking much of the physical effort out of the job.
- SAFETY:** Keep a clean uncluttered area by eliminating the hazard of a loose hose.
- VERSATILE:** Duro Reels have hundreds of varied applications. They can be customized to fit the job.
- LONGEVITY:** Low maintenance factor. The need to replace hose is greatly reduced. A most economical and high quality hose reel. The fine choice of materials with designed in features give our products and advantage for greater longevity.



SERVICE PERFECTED

AUTOMATIC REWIND

Heavy solid spun steel disc with beaded edges for maximum protection of hose.

Long life nylon hose rollers turn on solid steel pins.

Roller guide and arm are adjustable to all working positions with one nut adjustment.

Replaceable spring type cartridge house's motor spring and arbor that is safe to handle and simple to replace.

All brass swivel joint with double O-ring seals, secured independently from other moving parts.

Flexible lead-in line with female connector for easy hook up.

Plastic hose protector on working end of hose.

One piece reusable type ball stop is adjustable anywhere along hose.

High grade 300 PSI flexible hose.

Heavy fabricated steel base with slotted mounting holes for easy installation.

All hose threads are standard NPT threads.

Reel turns on self-lubricating bearing. No oil required.

Positive multi-position lock ratchet made of non-sparking material.

* Parts are painted or treated before assembly.
All standard N.P.T. threads.

High grade blue steel motor spring balanced in a container with a back-lash arbor.

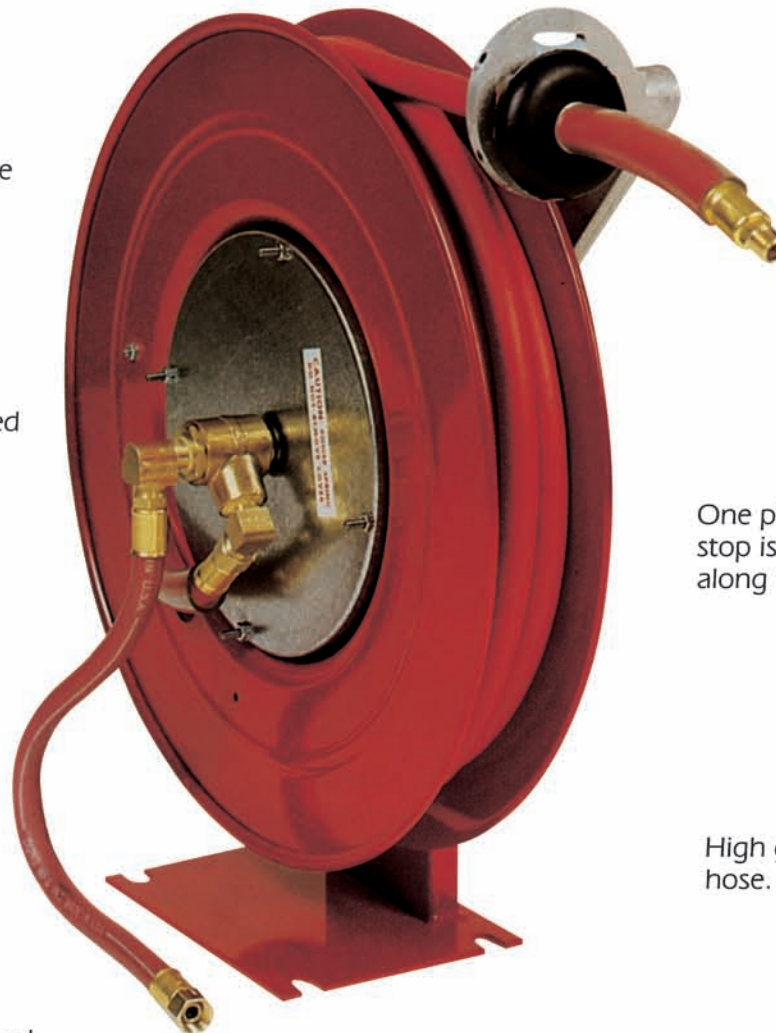

1400 Series

DURO REELS ARE BETTER

"A creative leadership of new ideas and think ahead quality designs."

HEAVY DUTY HOSE REELS

MEDIUM AND HIGH PRESSURE LOW PRESSURE AIR, WATER AND OIL

Ideal for large service areas where longer hose lengths are required. Truck terminals, industrial applications and service centers. Hose reels with extra long lengths of hose.

Roller guide arm may be adjusted for top, bottom or ceiling.

One piece ball stop is adjustable anywhere along hose length

All standard N.P.T. threads.

Multi-Lock latch
Non sparking pawl.

Cartridge type motor spring made with high grade blue steel with backlash release.

Heavy 11 gauge frame supports spool on both sides.

Solid cast alloy axle supported on both sides with 1 1/4" pillow block bearings.

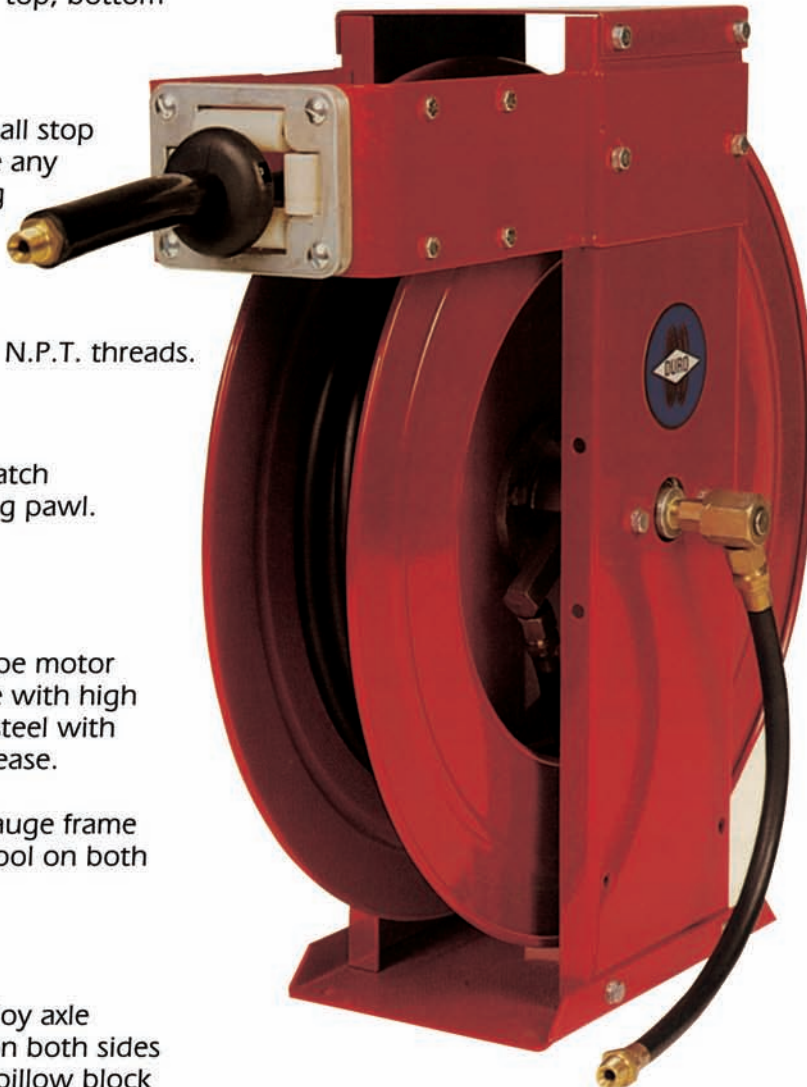

Solid heavy spun steel reel disc with beaded edges for maximum protection of hose.

Accessible swivel joints 1/4" to 3/4".

Flexible lead-in line for easy hook-up.

Reels may be stacked in any configuration. (See page 11)

Knock down mounting base reel is easily assembled for right or left hand rewind, top or bottom rewind and swivel on left or right.

2100 Series

Extra long hose lengths up to 100'

DURO REELS ARE BETTER
"A practical solution to many problems"

1200 & 1300 HEAVY DUTY HOSE REELS

MEDIUM & HIGH PRESSURE LOW PRESSURE AIR, WATER & OIL

Ideal for large service areas where longer hose lengths are required. Truck terminals, industrial applications and service centers. Hose reels with extra long lengths of hose.



FEATURES

- High grade blue steel motor spring matched and balanced to fit the job.
- Reel turns on bronze self-lubricating bearing fitted to solid 1" diameter axle.
- Heavy fabricated steel base with slotted mounting holes for easy installation.
- Multi-position ratchet pawl made of non sparking material.
- Parts are powder coated or treated before assembly.
- Heavy solid spun steel disc with beaded edges for maximum protection of hose.
- Aluminum spring arbor releases spring in case of backlash.
- One piece reusable type ball stop is adjustable any where along hose.
- Flexible lead-in line with female connector for easy hook up.
- Plastic hose protector on working end of hose.
- All standard N.P.T. threads.
- All brass swivel joint with double O-ring seals. Secured independently from other moving parts.



F.O.B. Factory

(For mounting plates and enclosures see pages 22, 23 and 24)

NOTE: Other reel sizes for specific space and hose length are available. (Consult factory.) All reels are furnished for overhead mounting unless otherwise specified. Standard color is red. All threads are standard N.P.T. to hose sizes unless otherwise specified.

HEAVY DUTY HOSE REELS

MEDIUM AND HIGH PRESSURE FOR CEILING, WALL OR FLOOR MOUNT

1200

LOW PRESSURE AIR-WATER

Model Number	Hose Length	Hose I.D.	Shipping Weight	Dimension Chart
1201	50 feet	1/4"	54	1
1202	60 feet	1/4"	55	1
1203	70 feet	1/4"	61	1
1204	80 feet	1/4"	68	2
1209	50 feet	3/8"	56	3
1210	60 feet	3/8"	63	4
1211	70 feet	3/8"	70	4
1212	80 feet	3/8"	72	4
1213	35 feet	1/2"	59	5
1214	50 feet	1/2"	72	6
1215	60 feet	1/2"	75	6

LOW PRESSURE OIL REELS 1000 PSI

1216	25 feet	3/8"	53	3
1217	35 feet	3/8"	56	3
1218	50 feet	3/8"	59	3
1219	25 feet	1/2"	54	5
1220	35 feet	1/2"	57	5
1221	50 feet	1/2"	60	6

1300

MEDIUM PRESSURE 2500 PSI

Model Number	Hose Length	Hose I.D.	Shipping Weight	Dimension Chart
1301	20 feet	3/8"	52	1
1302	30 feet	3/8"	55	1
1303	40 feet	3/8"	57	1
1304	50 feet	3/8"	65	2
1305	20 feet	1/2"	53	3
1306	30 feet	1/2"	55	3
1307	40 feet	1/2"	66	4
1308	50 feet	1/2"	68	4

LOW PRESSURE FUEL 200 PSI

1309	20 feet	3/4"	66	5
1310	25 feet	3/4"	68	5

HIGH PRESSURE 5000 PSI

1311	20 feet	1/4"	51	3
1312	25 feet	1/4"	53	3
1313	30 feet	1/4"	55	3
1314	40 feet	1/4"	58	3
1315	50 feet	1/4"	59	3
1316	20 feet	3/8"	51	3
1317	25 feet	3/8"	53	3
1318	30 feet	3/8"	55	3
1319	40 feet	3/8"	58	3
1320	50 feet	3/8"	60	3

1200

DIMENSION CHART

	A	B	C	D	E
1	20"	21"	7"	7"	13"
2	22"	23"	7"	7"	13"
3	20"	21"	7 1/2"	7"	13"
4	22"	23"	7 1/2"	7"	13"
5	20"	21"	8"	7"	13"
6	22"	23"	8"	7"	13"

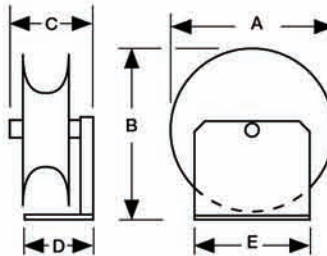

1300

DIMENSION CHART

	A	B	C	D	E
1	20"	21"	9 1/4"	7"	13"
2	22"	23"	9 1/4"	7"	13"
3	20"	21"	9 1/4"	7"	13"
4	22"	23"	9 1/4"	7"	13"
5	22"	23"	10 1/2"	7"	13"

NOTE: Other reel sizes for specific space and hose length are available. (Consult factory.) All reels are furnished for overhead mounting unless otherwise specified. Standard color is red. All threads are standard N.P.T. to hose sizes unless otherwise specified.

STANDARD DUTY 1400 & 1500

SHOP & AUTOMOTIVE REELS LOW PRESSURE AIR, OIL AND NITROGEN

GENERAL APPLICATION

For service station, garage, tire centers or factory — where orderly dispensing of water or compressed air may be required.

- **TIRE INFLATION • PNEUMATIC TOOLS • BLOWGUNS**
- **SPRAY PAINTING • FOOD PROCESSING • WASHDOWN**



FEATURES

- Sealed and lubricated motor springs assure longer life. Centrifugally aligned, with built in de-clutching device to protect against backlash, avoiding premature spring failure.
- Independent rotating all brass swivel joints, each with four (4) "O" ring seals. Large orifice permits maximum flow.
- Non-sparking positive locking and releasing ratchet, for tension free hose. Heavy self-lubricated bronze thrust type bearing for added life.
- Cast aluminum hose guides with quiet friction free nylon rollers. Adjustable to assure proper alignment with hose.
- Highest quality hose with standard female fittings for installation. One piece adjustable hose ball stop can be secured any place along the hose length.
- Sturdy mounting base with slotted holes for easy installation. Flexible inlet source line makes an easy hook up. Extra large safety axle. Heavy steel reel disc's are beaded for extra rigidity. All materials are protected against rust by heavy powder coat, cadmium plate, heat treated aluminum, bronze, brass or other conversion coatings.



F.O.B. Factory

(For mounting plates and enclosures see pages 22, 23 and 24)

SHOP & AUTOMOTIVE REELS

FOR CEILING, WALL, OR FLOOR MOUNT 300 PSI

SINGLE REELS — OPEN TYPE

1400

LOW PRESSURE AIR-WATER

Model Number	Hose Length	Hose I.D.	Shipping Weight	Dimension Chart
1401	20 feet	1/4"	25	1
1402	25 feet	1/4"	27	1
1403	30 feet	1/4"	28	2
1404	35 feet	1/4"	30	2
1405	40 feet	1/4"	34	3
1406	50 feet	1/4"	35	3
1413	20 feet	3/8"	26	4
1414	25 feet	3/8"	30	5
1415	30 feet	3/8"	32	5
1416	35 feet	3/8"	34	6
1417	40 feet	3/8"	35	6
1418	50 feet	3/8"	40	7
1419	20 feet	1/2"	37	8
1420	25 feet	1/2"	40	9

LOW PRESSURE OIL

1422	25 feet	3/8"	32	5
1424	25 feet	1/2"	40	9

LOW PRESSURE NITROGEN

1416-N	35 feet	3/8"	34	6
1418-N	50 feet	3/8"	40	7

1400

DIMENSION CHART

	A	B	C	D	E
1	14"	15 1/2"	7 1/2"	6"	8"
2	16"	17 1/2"	7 1/2"	6"	8"
3	18"	19"	7 1/2"	6"	8"
4	14"	15 1/2"	7 3/4"	6"	8"
5	16"	17 1/2"	7 3/4"	6"	8"
6	16"	17 1/2"	7 3/4"	6"	8"
7	18"	19"	7 3/4"	6"	8"
8	18"	19"	8 1/2"	6"	8"
9	18"	19"	8 1/2"	6"	8"

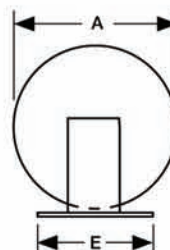
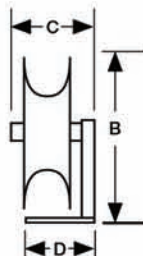

DOUBLE REELS — OPEN TYPE

1500

LOW PRESSURE AIR-WATER

Model Number	Hose Length	Hose I.D.	Shipping Weight	Dimension Chart
1501	20 & 20 feet	1/4"	51	1
1502	25 & 25 feet	1/4"	53	1
1503	30 & 30 feet	1/4"	56	2
1504	35 & 35 feet	1/4"	60	2
1505	40 & 40 feet	1/4"	68	3
1506	50 & 50 feet	1/4"	70	3
1513	20 & 20 feet	3/8"	52	4
1514	25 & 25 feet	3/8"	58	5
1515	30 & 30 feet	3/8"	60	5
1516	35 & 35 feet	3/8"	70	6
1517	40 & 40 feet	3/8"	72	6
1518	50 & 50 feet	3/8"	75	7
1519	20 & 20 feet	1/2"	64	8
1520	25 & 25 feet	1/2"	68	8

LOW PRESSURE OIL

1522	25 & 25 feet	3/8"	65	5
1524	25 & 25 feet	1/2"	68	9

1500

DIMENSION CHART

	A	B	C	D	E
1	14"	17"	12 1/2"	11 1/2"	8"
2	16"	19"	12 1/2"	11 1/2"	8"
3	18"	22 1/2"	12 1/2"	11 1/2"	8"
4	14"	17"	13"	11 1/2"	8"
5	16"	19"	13"	11 1/2"	8"
6	18"	22 1/2"	14 1/2"	11 1/2"	8"
7	18"	22 1/2"	14 1/2"	11 1/2"	8"
8	18"	22 1/2"	14 1/2"	11 1/2"	8"

NOTE: Other reel sizes for specific space and hose length are available. (Consult factory.) All reels are furnished for overhead mounting unless otherwise specified. Standard color is red. All threads are standard N.P.T. to hose sizes unless otherwise specified.

1600 & 1700 ENCLOSED LOW PRESSURE AIR & WATER

GENERAL APPLICATION

Totally enclosed reels for service station lube rooms, service yard or pump islands, garage centers, commercial kitchens or dairies. Used indoors or outdoors where appearance and hose protection is required. Mounts to ceiling, wall or floor.

FEATURES

- All brass swivel joint with double O-ring seals. Secured independently from other moving parts.
- Heavy fabricated steel base with slotted mounting holes for easy installation.
- Multi-position ratchet pawl made of non sparking material.
- Parts are painted or treated before assembly.
- High grade blue steel motor spring matched and balanced to fit the job.
- Reel turns on bronze self-lubricating bearing.
- Plastic hose protector on working end of hose.

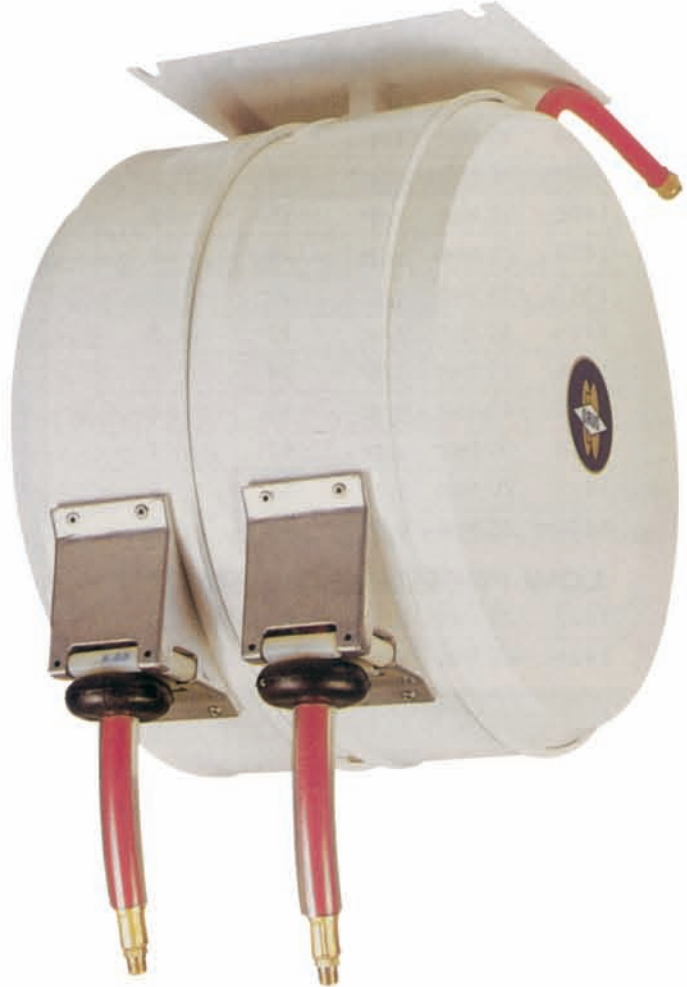

ENCLOSURE

Attractive, beautifully finished enclosures may be had in any color, white is standard. Roller outlets are easily adjusted for ceiling, wall or floor. Two screws give accessibility to reels.

HOSE AND INLET SOURCE LINES

Hose supplied with standard female swivel pipe fittings for easy installation. One piece adjustable hose stop can be installed any place along the hose length. Independent flexible inlet lines with female fittings for easy hook-up.

F.O.B. Factory

(See other enclosures on pages 22 and 23)

ENCLOSED HOSE REELS

SINGLE & DOUBLE ENCLOSED

1600

SINGLE ENCLOSED

Model Number	Hose Length	Hose I.D.	Shipping Weight
1601	20 feet	1/4"	31
1602	25 feet	1/4"	32
1603	30 feet	1/4"	34
1604	35 feet	1/4"	35
1608	20 feet	3/8"	32
1609	25 feet	3/8"	33
1610	35 feet	3/8"	35
1611-L	50 feet	1/4"	45
1613-L	50 feet	3/8"	48
1614-L	25 feet	1/2"	46

1700

DOUBLE ENCLOSED

Model Number	Hose Length	Hose I.D.	Shipping Weight
1701	20 & 20 feet	1/4"	53
1702	25 & 25 feet	1/4"	58
1703	30 & 30 feet	1/4"	60
1704	35 & 35 feet	1/4"	64
1708	20 & 20 feet	3/8"	58
1709	25 & 25 feet	3/8"	64
1710	35 & 35 feet	3/8"	68
1711-L	50 & 50 feet	1/4"	74
1713-L	50 & 50 feet	3/8"	80
1714-L	25 & 25 feet	1/2"	70

1600 & 1700

DIMENSION CHART

	A	B	C	D	E
1600	15 1/2"	17"	8"	6"	8"
1700	15 1/2"	17"	13"	11 1/2"	8"
1600-L	18"	20"	8"	6"	8"
1700-L	18"	20"	13"	11 1/2"	8"

MOUNTING HOLES: 1600 - 4 1/2" X 7" centers
1700 - 7" X 10" centers

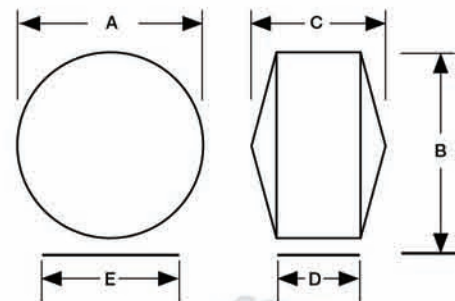

MATERIALS

All materials other than bronze or brass are protected against rust by a heavy powder coat, cadmium plating or other conversion materials.

Hose roller outlet positioned for ceiling mount unless otherwise specified on order.

Standard finish is white powder coat. Enclosures can be furnished in chrome, bright plate or stainless steel at extra cost.

1700 series available with other combinations of hose lengths and sizes, please specify.

F.O.B. Factory

1800 RETRACTABLE WELDING REEL

SINGLE & DOUBLE REELS FOR BI-LINE HOSE COMBINATION WELDING, AIR OR WATER

For more efficiency in high production shop's • Keeps a clean, uncluttered shop and eliminates unneeded cleanup time • Replacement hoses greatly reduced • Saves pick up time on portable equipment • A variety of combinations are offered.

FEATURES

- Sealed motor spring with built in de-clutching arbor. Balanced to give a nearly constant load when extending hose.
- Hose is held out at any working length tension free, by a non-gravity and non-sparking type locking pawl. A slight tug of the hose releases for automatic rewind.
- Cast aluminum hose arm guides are adjustable to all working positions. Ceiling, wall or floor. Quiet, safe, friction free nylon rollers mean less wear to hose lengths.
- Swivel joints have dual housings on a single shaft. Independent housings prevent possible mixture of gases. Swivel is easily removed as one part.
- Reel spools are heavy smooth beaded steel to provide maximum protection for hose chafing. Heavy self-lubricating main bearing pressed into cast aluminum axle hub. All materials are protected against rust by heavy powder coating, cadmium plate or other conversion coatings.

F.O.B. Factory

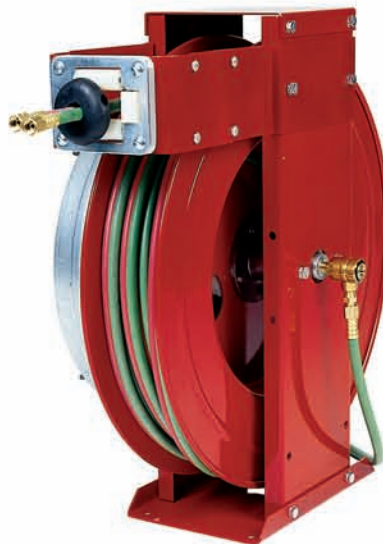

SERIES 1800 SINGLE & DOUBLE WELDING REELS

Order by this number

When ordering specify hose I.D.

SINGLE REELS FOR TWIN WELDING HOSE (3/16 I.D. AND 1/4 I.D.)

Model Number	Hose Capacity	Hose I.D.	Shipping Weight	Dimension Number
1804	25 feet	3/16" or 1/4"	31	1
1805	30 feet	3/16" or 1/4"	37	2
1806	35 feet	3/16" or 1/4"	38	2
1807	40 feet	3/16" or 1/4"	40	2
1808	50 feet	3/16"	43	2

HEAVY DUTY SINGLE REELS FOR TWIN WELDING HOSE

1809	50 feet	3/16" or 1/4"	67	5
1810	65 feet	1/4"	72	5
1811	75 feet	3/16"	70	5

DOUBLE REELS FOR TWIN WELDING HOSE (3/16 I.D. AND 1/4 I.D.)

(Two twin hose reels on one mounting base)

1813	25 & 25 feet	3/16" or 1/4"	62	3
1814	35 & 35 feet	3/16" or 1/4"	66	4
1815	40 & 40 feet	3/16" or 1/4"	72	4
1816	50 & 50 feet	3/16"	78	4

DOUBLE REELS FOR TWIN WELDING AND WATER HOSE

(One welding hose reel and one water hose reel on one mounting base.)

Model Number	Welding Hose Size	Water or Air Hose Size	Shipping Weight	Dimension Number
1820	25 feet 3/16"	25 feet 3/8"	60	3
1821	35 feet 3/16"	35 feet 3/8"	65	4
1822	50 feet 3/16"	50 feet 3/8"	70	4

Other combinations of hose lengths and sizes available on request

SERVICE TRUCK WELDING REEL

Heavy duty with extra long hose lengths

1830	100 feet	3/16"	96	6
1831	100 feet	1/4"	95	6

NOTE: Grade 'T' hoses available upon request. For hand crank reels consult factory.

OVERALL DIMENSIONS

Dimension Number	Diameter	Height	Width	Center Lines of Mounting Holes
1	16"	17 1/2"	7 3/4"	4 1/2" X 7"
2	18"	21"	7 3/4"	4 1/2" X 7"
3	16"	19"	14"	7" X 10"
4	18"	22 1/2"	14"	7" X 10"
5	22"	23"	9"	6" X 10 1/2"
6	22"	24 1/2"	16"	6" X 10 1/2"

F.O.B. Factory

(For mounting plates see page 24)

1900 MEDIUM DUTY HOSE REELS

LOW, MEDIUM & HIGH PRESSURE AIR, WATER, OIL & GREASE

Perfect for industrial & commercial shops, tire centers, automotive dealerships, service trucks & fleet maintenance facilities. Heavy gauge steel construction and powder coat finish. Solid steel spool with rolled edges for maximum hose protection and axle supported by dual support base and roller guide arms. Independent rotating swivel joints allow maximum flow. Non-sparking positive locking and release mechanism for tension free use. Cartridge type spring housing for safe and easy replacement.

1900

LOW PRESSURE AIR - WATER 300 PSI

Model Number	Hose Length	Hose I.D.	Shipping Weight
1901	50 feet	3/8"	50 lbs.
1902	50 feet	1/2"	56 lbs.

LOW PRESSURE OIL - ATF 1000 PSI

1903	50 feet	3/8"	59 lbs.
1904	50 feet	1/2"	60 lbs.

MEDIUM PRESSURE OIL - ATF 2500 PSI

1905	50 feet	3/8"	65 lbs.
1906	50 feet	1/2"	68 lbs.

HIGH PRESSURE CHASSIS 5000 PSI

1907	50 feet	1/4"	59 lbs.
------	---------	------	---------

HIGH PRESSURE CHASSIS 4000 PSI

1908	50 feet	3/8"	60 lbs.
------	---------	------	---------



Top Rewind



Ceiling Mount

DIMENSION CHART

Ceiling Mount

A	B	C	D	E
21"	8"	22 1/2"	10"	7"

TOP REWIND

A	B	C	D	E
21"	8"	21 1/2"	10"	7"

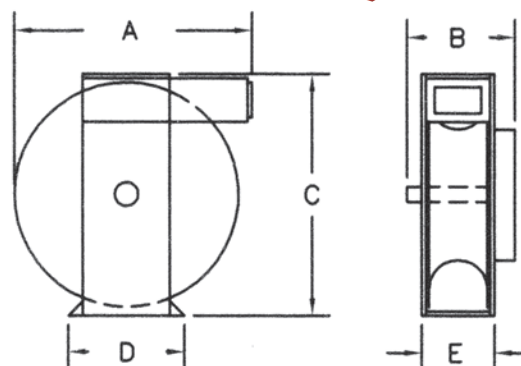

When Ordering specify Top Rewind or Ceiling Mount

2000 COMPACT UTILITY REEL

Size makes this reel ideal for mounting under work benches, in cabinets on or near machine shops or factory production lines. Wherever air tools are needed.

2000

SINGLE OPEN TYPE - 300 PSI

Model Number	Hose Size	Over All Size	Shipping Weight
2001	10 feet 1/4"	10 1/2" x 5" x 10 1/2"	10 lbs.
2002	15 feet 1/4"	10 1/2" x 5" x 10 1/2"	12 lbs.
2003	20 feet 1/4"	10 1/2" x 5" x 10 1/2"	14 lbs.
2004	10 feet 3/8"	10 1/2" x 5" x 10 1/2"	14 lbs.
Type-6	Enclosure	11" x 8" x 12 3/4"	9 lbs.



2050 COMPACT TRUCK REELS HEAVY DUTY

Perfect for small confined spaces on service trucks. Low, Medium and High Pressure reels for air, water, oils and chassis. Heavy fabricated steel base. Heavy solid spun steel disc with beaded edges for maximum hose protection, rotates on a bronze self-lubricating bearing fitted on a solid 1" diameter axle.

2050

LOW PRESSURE AIR-WATER 300 PSI

Model Number	Hose Length	Hose I.D.	Shipping Weight
2051	50 feet	3/8"	54 lbs.
2052	50 feet	1/2"	69 lbs.

MEDIUM PRESSURE MOTOR OIL-GEAR OIL-ATF 2500 PSI

2053	50 feet	3/8"	65 lbs.
2054	50 feet	1/2"	68 lbs.

HIGH PRESSURE CHASSIS 5000 PSI

2055	50 feet	1/4"	59 lbs.
2056	50 feet	3/8"	60 lbs.



Height 19" Width 8 5/8" Diameter 18"

2100

HEAVY DUTY HOSE REELS MEDIUM & HIGH PRESSURE, LOW PRESSURE AIR, WATER & OIL

Heavy duty reels built to withstand the rugged service of all lube and service trucks. Heavy 11 gauge steel base supports the reel on both sides. Self Aligning 1 1/4 bearings on both sides. Motor spring type cartridge makes for safe and easy replacement. Hose roller arm is supported on both sides and may be attached top or bottom. Base is designed for stacking reels one on another and secure with tie bar across top. Ceiling wall or floor mounting.

2100

LOW PRESSURE AIR-WATER 300 PSI			
Model Number	Hose Length	Hose I.D.	Shipping Weight
2101	50 feet	3/8"	75 lbs.
2102	60 feet	3/8"	90 lbs.
2103	50 feet	1/2"	81 lbs.
2104	60 feet	1/2"	90 lbs.
LOW PRESSURE MOTOR OIL-GEAR OIL-ATF 1000 PSI			
2105	50 feet	3/8"	80 lbs.
2106	60 feet	3/8"	87 lbs.
2107	50 feet	1/2"	82 lbs.
2108	60 feet	1/2"	89 lbs.
MEDIUM PRESSURE MOTOR OIL-GEAR OIL-ATF 2500 PSI			
2109	50 feet	3/8"	81 lbs.
2110	60 feet	3/8"	87 lbs.
2111	50 feet	1/2"	82 lbs.
2112	60 feet	1/2"	89 lbs.
HIGH PRESSURE CHASSIS 5000 PSI			
2113	50 feet	1/4"	80 lbs.
2114	60 feet	1/4"	87 lbs.
2115	50 feet	3/8"	83 lbs.
2116	60 feet	3/8"	90 lbs.
LOW PRESSURE FUEL 200 PSI			
2117	20 feet	3/4"	78 lbs.
2118	25 feet	3/4"	80 lbs.
LOW PRESSURE 300 PSI EXTRA LONG LENGTHS			
2119	100 feet	1/4"	98 lbs.
2120	100 feet	3/8"	100 lbs.

Longer hose lengths available on above hose reels (consult factory.)

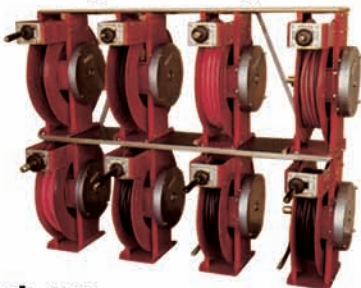

Stack-um

Top tie bar for any number of reels. (Specify)
Powder coat finish.

F.O.B. Factory

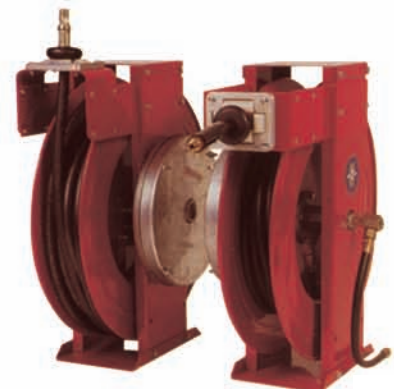
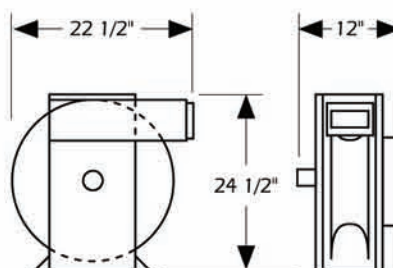

SERIES 2200 STATIC DISCHARGE REELS

Static discharge reels with 3/32 diameter 7x7 galvanized cable with orange vinyl coated cover
3/16 diameter 50 amp grounding clamp included. Available in three lengths.

Model Number	Capacity	Shipping Weight	Dimensions		
			H	W	L
2201	Less cable	21	13"	5"	12 1/2"
2202	50 feet Static cable	24	13"	5"	12 1/2"
2204	75 feet Static cable	27	13"	5"	12 1/2"
2205	Less cable	31	17"	5"	16"
2206	100 feet Static cable	40	17"	5"	16"
2209 SK	50 feet Static cable	21	13"	4"	12 1/2"
2210 SK	75 feet Static cable	24	13"	4"	12 1/2"

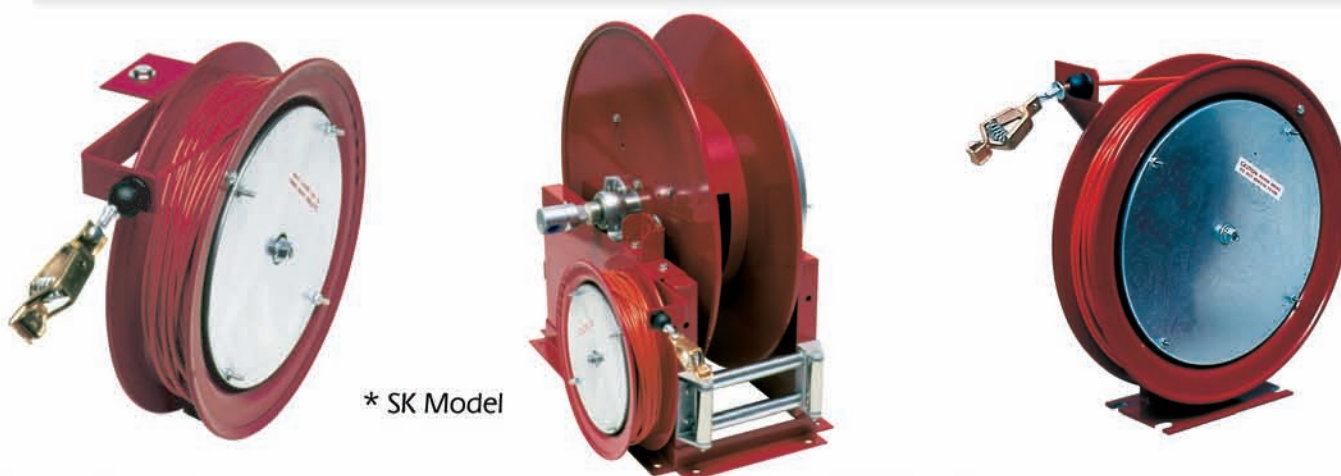

* Static Cable Reel secures to the side of any Series 3000, 3300 or 3400 Fuel Reel.

SERIES 2300

ELECTRIC CORD REEL FOR SHOP OR HOME. MANUAL WIND-UP

Spool wind up of extension cords with double receptacle and built in fuse switch. Heavy construction, easy wind up of extended cord. Units with heavier power cords, consult factory.



ELECTRIC CORD STORAGE 115 VOLT 13 & 15 AMPS.

Model Number	Description	Shipping Weight
2301	Reel Less Cord 15 amp.	10 lbs.
2302	Reel with 100 feet 16/3 SJEOOW 10 amp.	15 lbs.
2303	Reel with 100 feet 14/3 SJEOOW 13 amp.	16 lbs.
2304	Reel Less Cord 15 amp.	15 lbs.
2305	Reel with 150 feet 14/3 SJEOOW 13 amp.	22 lbs.
2306	Reel with 150 feet 12/3 SJEOOW 15 amp.	25 lbs.

F.O.B. Factory

SERIES 2400 WELDING CABLE REELS

Reel is equipped with 400 AMP continuous slip ring. Effectively stores cable neatly until ready for use. Sold with or without cable. Suitable for grounding work clamp or electrode holder.

	Model Number	Description	Shipping Weight
HAND CRANK	2401	Reel less cable 400 Amp	60 lbs.
	2402	150 feet of 2/0 Cable	120 lbs.
	2403	200 feet of 1/0 Cable	162 lbs.
SPRING RETRACTED	2404	Reel less cable 400 Amp	58 lbs.
	2405	50 feet of 2/0 Cable	78 lbs.
	2406	50 feet of 1/0 Cable	81 lbs.

	Height	Width	Diameter
Hand Crank	18"	21"	18"
Spring Retracted	21 3/4"	10"	20"



SERIES 2500 ELECTRIC CORD REELS

SPRING RETRACTED ELECTRICAL REEL

Electric cord reels with 30 AMP rated collector ring. Furnished with 13, 15 and 20 AMP SJEOOW wire for indoor commercial electrical power application. All cords supplied with inlet and outlet plugs at wire AMP rating. Heavy duty all steel construction with options (see options)

- Rated 115 volt 60 Hz single phase only. (For Indoor Use)

Guide arm adjusts for floor ceiling or wall. Cord locks out at working position.

Model Number	Capacity	Shipping Weight	Dimensions
2501	50 feet of 16/3 SJEOOW 13 amp	35	Height 15"
2502	50 feet of 14/3 SJEOOW 15 amp	37	Width 10"
2503	50 feet of 12/3 SJEOOW 20 amp	40	Diameter 14"



When ordering option, add symbol to model number (2501-D)

* Available for 12 volts

OPTIONS FOR SERIES 2300, 2500 AND 2600

Model Number	
BC	Caged industrial drop light with tap plug
C	Caged general purpose drop light with tap plug
*D	Fluorescent light fixture with tap plug. Available for 16/3 wire, 13 amps only
E	Double industrial receptacle



F.O.B. Factory

SERIES 2600 ELECTRIC CORD REELS

HEAVY DUTY ELECTRIC REEL 45 AMP COLLECTOR RING

Spring operated reel for live electricity. Wire SEOOOW 10 and 12 gauge 3 conductor. 45 AMP collector ring with a 6 foot inlet cable to match working cable. All cables less attachments (specify type.) All steel construction with powder coat finish. The cable guide arm adjusts for ceiling, wall or floor.

Specify on plugs & receptacles. Twist lock or other types.

Model Number	Description	Shipping Weight
2601	Reel less cord 3 conductor	58
2602	Reel with 50 feet SEOOOW 12/3 20 Amp	62
2603	Reel with 50 feet SEOOOW 10/3 30 Amp	65
2604	Reel less cord 4 conductor	59
2605	Reel with 50 feet SEOOOW 12/4 20 Amp	68
2606	Reel with 50 feet SEOOOW 10/4 30 Amp	72



Height 22" Width 14" Diameter 20"

SERIES 2700 ELECTRIC CORD REELS

ELECTRIC CORD REEL AND AIR HOSE ON ONE MOUNTING BASE COMBINATION ELECTRIC CORD WITH 1/4" AIR OR WATER HOSE.

Electric cord reels with 30 AMP rated collector ring. Furnished with 16, 14 and 12 GA. SJEOOW wire for indoor commercial electrical power application. All cords supplied with inlet and outlet plugs at wire AMP rating. Heavy duty all steel construction with options (see options).

*Reel rated 115 volt 60 Hz single phase only. (For Indoor Use)

Guide arm adjusts for floor ceiling or wall. Cord locks out at working position.

Model Number	Description	Shipping Weight
2701	Reel with 50 ft. 16/3 wire & 35 ft. 1/4" Air or Water	48
2702	Reel with 50 ft. 14/3 wire & 35 ft. 1/4" Air or Water	50
2703	Reel with 50 ft. 12/3 wire & 35 ft. 1/4" Air or Water	53
2704	Reel with 50 ft. 16/3 wire & 35 ft. 3/8" Air or Water	50
2705	Reel with 50 ft. 14/3 wire & 35 ft. 3/8" Air or Water	53
2706	Reel with 50 ft. 12/3 wire & 35 ft. 3/8" Air or Water	57
2751	50 feet of 16/3 SJEOOW 13 amp.	27
2752	50 feet of 14/3 SJEOOW 15 amp.	29
2753	50 feet of 12/3 SJEOOW 20 amp.	32

NOTE: Longer hose lengths available consult factory.

Single: Height 17" Width 9" Diameter 14"

Double: Height 18" Width 14" Diameter 14" F.O.B. Factory



2700-E COMBINATION & 2750-E SINGLE ENCLOSED ELECTRIC CORD REELS

Enclosed combination electric & air/water reels and single electric reels with 30 AMP rated collector ring. Furnished with 16, 14 and 12 gauge SJEOOW wire for indoor commercial electrical power applications. Rated 115 volt 60 Hz single phase only (for indoor use). All cord supplied with inlet and outlet plugs at wire amp rating. Air/water hose 300 psi working pressure. Attractive steel enclosures painted in white powder coat finish (other color options available). Enclosures can also be furnished in chrome or stainless steel. Roller outlets are easily adjustable for ceiling, wall or floor mount.

Model Number	Description	Shipping Weight
2704-E	Reel with 50 ft. 16/3 wire & 35 ft. 3/8" air or water	50
2705-E	Reel with 50 ft. 14/3 wire & 35 ft. 3/8" air or water	53
2706-E	Reel with 50 ft. 12/3 wire & 35 ft. 3/8" air or water	57
2751-E	Reel with 16/3 wire 13 amp.	28
2752-E	Reel with 14/3 wire 15 amp.	30
2753-E	Reel with 16/3 wire 20 amp.	35



DIMENSION CHART					
Model	A	B	C	D	E
2704-E	15½"	17"	13"	11½"	8"
2705-E	15½"	17"	13"	11½"	8"
2706-E	15½"	17"	13"	11½"	8"
2751-E	15½"	17"	8"	6"	8"
2752-E	15½"	17"	8"	6"	8"
2753-E	15½"	17"	8"	6"	8"

MOUNTING HOLES: 2750-E 4 1/2" x 7" centers
2700-E 7" x 10" centers

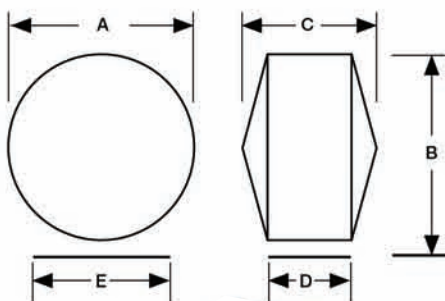

F.O.B. Factory

SERIES 2900 HAND REWIND

Direct rewind by side hand crank. Suitable for most liquids or gases.
All standard models re-wind clockwise. Furnished in red powder coat finish.

1/4" TO 1" HOSE SIZE

Model Number	I.D. O.D.	HOSE CAPACITY							Shipping Weight
		1/2" 5/8"	3/8" 3/4"	1/2" 7/8"	3/4" 1 1/4"	1" 1 1/2"	1 1/4" 1 3/4"	1 1/2" 2"	
2901		120'	75'	70'					37 lbs.
2902		180'	135'	125'					40 lbs.
2903		225'	165'	130'					50 lbs.
2904		375'	270'	185'					53 lbs.
2905				115'	40'				55 lbs.
2906				165'	65'				58 lbs.
2907				225'	110'				65 lbs.
2908				330'	170'				68 lbs.
2909						35'			53 lbs.
2910						60'			55 lbs.
2911						75'			65 lbs.
2912						125'			68 lbs.
2913		250'	160'	145'					42 lbs.
2914		315'	200'	175'					45 lbs.
2915		450'	335'	235'					53 lbs.
2916		590'	415'	330'					56 lbs.
2917							75'	50'	80 lbs.

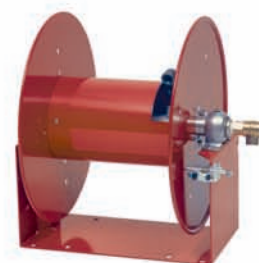

Evenly wound hose increases capacity of spools twenty percent or more.

DIMENSIONAL CHART									
Model Number	A	B	C	D	E	F	G	H	Inlet Size
2901	15 1/2"	21"	14"	7"	8"	13"	9"	8 1/2"	1/2"
2902	15 1/2"	25"	14"	7"	12"	17"	9"	8 1/2"	1/2"
2903	19 1/4"	21"	18"	7"	8"	13"	9"	10 1/2"	1/2"
2904	19 1/4"	25"	18"	7"	12"	17"	9"	10 1/2"	1/2"
2905	19 1/4"	21"	18"	9"	8"	13"	9"	10 1/2"	3/4"
2906	19 1/4"	25"	18"	9"	12"	17"	9"	10 1/2"	3/4"
2907	25"	21"	24"	9"	8"	13"	15"	13"	3/4"
2908	25"	25"	24"	9"	12"	17"	15"	13"	3/4"
2909	19 1/4"	21"	18"	9"	8"	13"	9"	10 1/4"	1"
2910	19 1/4"	25"	18"	9"	12"	17"	9"	10 1/4"	1"
2911	25"	21"	24"	9"	8"	13"	15"	13"	1"
2912	25"	25"	24"	9"	12"	17"	15"	13"	1"
2913	15 1/2"	29"	14"	9"	16"	21"	9"	8 1/2"	1/2"
2914	15 1/2"	33"	14"	9"	20"	25"	9"	8 1/2"	1/2"
2915	19 1/4"	29"	18"	9"	16"	21"	9"	10 3/4"	1/2"
2916	19 1/4"	33"	18"	9"	20"	25"	9"	10 3/4"	1/2"
2917	25"	27"	24"	12"	14"	19"	15"	13"	1 1/2"

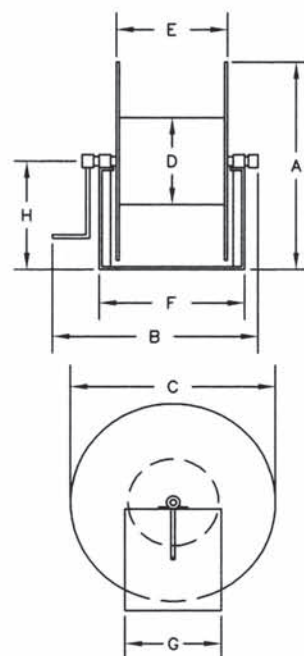

Reels are sold less hose.

NOTE: For portable carts, high-pressure applications, custom reel sizes and capacity consult factory.

SERIES 3000 HOSE REELS

SPRING REWIND 1/4" TO 1 1/2" SINGLE OPEN TYPE

Designed for general use where one hose is required. Spring operated for frequent use. Will handle most liquids and gases.

ORDER BY THIS NUMBER (Add variations)

Model Number	Hose Size	Hose Capacity	Shipping Weight	Index
3001	1/4" or 3/8 "	125 feet	88	1
3002	1/2"	75 feet	83	1
3003	1/2"	100 feet	88	1
3006	3/4"	50 feet	90	1
3007	3/4"	75 feet	95	2
3010	1"	35 feet	78	1
3001	1"	50 feet	94	2
3012	1"	75 feet	96	3
3015	1 1/4	20 feet	92	1
3016	1 1/4"	35 feet	94	2
3020	1 1/4	20 feet	96	2
3021	1 1/2	35 feet	98	3
3022	1 1/2"	50 feet	105	4

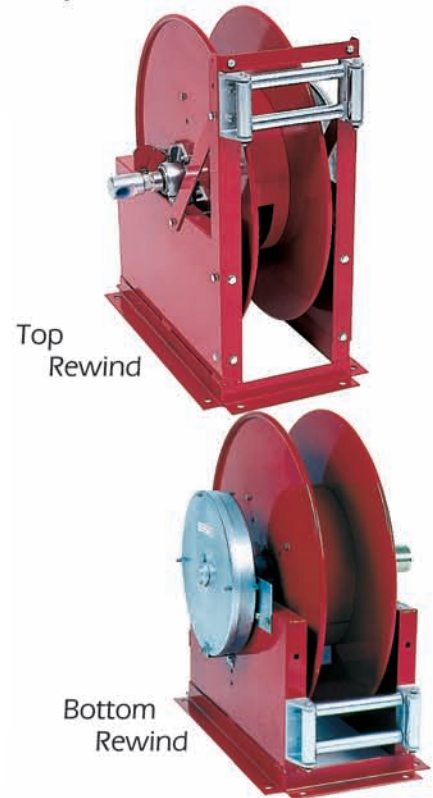

NOTE: High-pressure applications available consult facotry.

SERIES 3100 HOSE REELS

Designed for general use where two hoses are required on on reel. Will handle most liquids and gases. Inlet swivel on both sides.

3101	1/4" or 3/8"	50 feet to 70 feet	83	1
3102	1/4" or 3/8"	75 feet to 100 feet	95	2

OPTION		Shipping Weight
Symbol	Description	
TR 2	Top Rewind Roller w/ Brackets 3000 & 3100	8

3000 & 3100				
Size Index	A	B	C	D
1	24"	26"	15"	5"
2	24"	26"	17"	7"
3	24"	26"	21"	11"
4	20"	22"	26"	16"

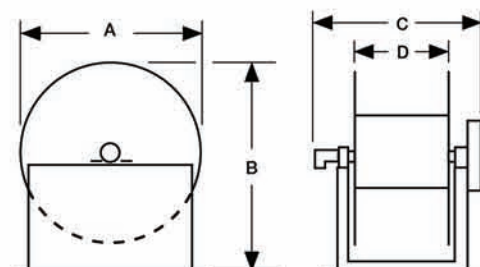

Zinc or Nickel plated reels available on request.

F.O.B. Factory

SERIES 3200 HOSE REELS

POWER REWIND 1/4" TO 1"

CONSTRUCTION:

- All steel frame and spool • Spool rotates on large pillow block self-aligning bearings • Cast aluminum axle with steel risers handles most liquid and gases at 1000 p.s.i. • Chain and sprocket powered by electric or air motor • Electric motors are AC or DC with permanent magnet • Interchangeable lead wires for reverse • Reels are powder coated before assembly

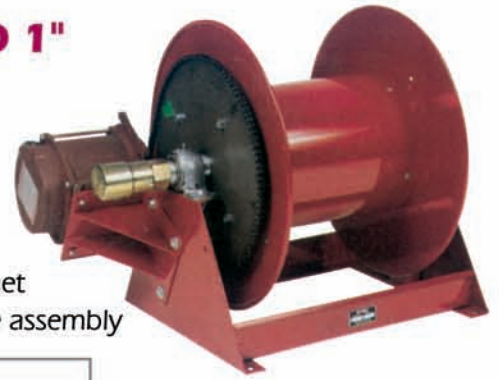

HOSE CAPACITY

Model Number	I.D. O.D.	1/4" 5/8"	3/8" 3/4"	1/2" 7/8"	3/4" 1 1/4"	1" 1 1/2"	Inlet Outlet
3201		* 220'	* 160'	100'			1 1/2"
3202		* 370'	* 260'	140'			2 1/2"
3203		* 450'	* 335'	225'			3 1/2"
3204		* 600'	* 425'	300'			4 1/2"
3205					50'	35'	1 1"
3206					75'	60'	2 1"
3207					120'	80'	3 1"
3208					150'	100'	4 1"

STANDARD REEL: Motor and inlet swivel located on left hand side with a top rewind. Standard color Red, specify other configurations and color.

SIZE INDEX

Index Number	Overall Size							Shipping Weight
	A	B	C	D	E	F	G	
1	19 1/2"	18"	18 1/2"	9"	8"	13 1/2"	16"	75
2	19 1/2"	22"	18 1/2"	9"	12"	17 1/2"	16"	80
3	19 1/2"	26"	18 1/2"	9"	16"	21 1/2"	16"	85
4	19 1/2"	30"	18 1/2"	9"	20"	25 1/2"	16"	90

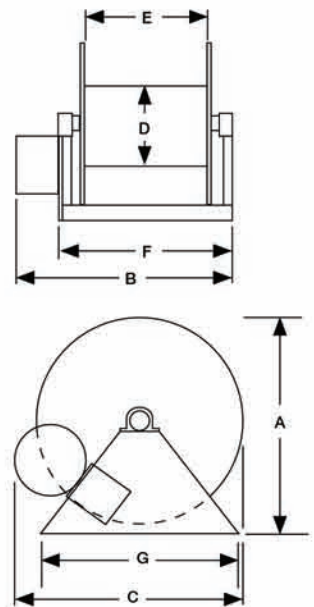

BASIC REEL IS LESS MOTOR: Add symbol for desired power.

OPTIONS TO BASIC REEL

Symbol	Description	Shipping Weight
DC	DC non-explosion proof 12V 1/3 HP	12
DCE	DC explosion proof 12V 1/2 HP	16
ACE	AC explosion proof 115V 1/2 HP	16
A	Air motor	12

F.O.B. Factory

SERIES 3300, 3350 & 3400 HOSE REELS

POWER REWIND 1/4" TO 1 1/2"

CONSTRUCTION

- All welded steel frame
- Heavy gage steel spool with rolled edge's
- Spool turns on pillow block bearings
- Aluminum axle and steel riser will handle most liquid and gases
- All fabricated steel parts painted with baked powder coat before assembly.

STANDARD REEL (Looking at front of hose reel)

- Motor is mounted on left hand side rear
- Swivel inlet on left hand side
- Top hose rewind on spool
- Reels sold less hose

MODEL 3350

When two hoses of equal size and length are required on one reel spool. Each hose has its own inlet swivel and rewinds on a divided spool Other sizes available.

HOW TO ORDER:

When ordering power hose reel, give model number first then add type of power symbol. (example 3402-DCE.)

After ordering hose reel with desired type of power, add symbol for additional options. (example 3402-DCE-LR.)

Specify other configurations when needed.



Top Rewind



Model 3350



Bottom Rewind

F.O.B. Factory

OPTIONS TO BASIC REEL

Symbol	Description	Shipping Weight
DCE	DC Explosion Proof 1/2 H.P. 12V	16
ACE	AC Explosion Proof 1/2 H.P. 115V	16
A	Air-Motor	12
LR	Single Lower Roller	5
TR1	Top Rewind Roller w/Brackets	8

SERIES 3300 HOSE REELS

HOSE CAPACITY

Model Number	I.D. O.D.	1/4" 5/8"	3/8" 3/4"	1/2" 7/8"	3/4" 1 1/4"	1" 1 1/2"	Size Index	Inlet Outlet
3301		400'	280'	240'			1	1/2"
3302		650'	460'	400'			2	1/2"
3303		700'	500'	410'			3	1 1/2"
3304					110'		1	3/4"
3305					200'		2	3/4"
3306					210'		3	3/4"
3307						135'	4	1"
3308						240'	5	1"

SERIES 3350 HOSE REELS

HOSE CAPACITY

Model Number	I.D. O.D.	1/4" 5/8"	3/8" 3/4"	1/2" 7/8"	3/4" 1 1/4"	Size Index	Inlet Outlet
3351		325'	225'	175'		3	1/2"
3352					100'	3	3/4"

SERIES 3400 HOSE REELS

HOSE CAPACITY

Model Number	I.D. O.D.	1" 1 1/2"	1 1/4" 1 3/4"	1 1/2" 2"	Size Index	Inlet Outlet
3401		185'			6	1"
3402		350'			7	1"
3403			80'		4	1 1/4"
3404			150'		5	1 1/4"
3405			160'		6	1 1/4"
3406			250'		7	1 1/4"
3407				60'	4	1 1/2"
3408				110'	5	1 1/2"
3409				110'	6	1 1/2"
3410				200'	7	1 1/2"

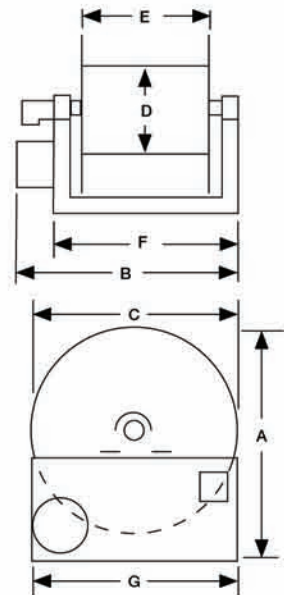

SIZE INDEX

Index Number	A	B	C	D	E	F	G	Shipping Weight
1	20"	25"	18"	9"	12"	18"	18"	89
2	20"	33"	18"	9"	20"	26"	18"	92
3	25"	25"	24"	9"	12"	18"	22"	99
4	25"	25"	24"	12"	12"	18"	22"	104
5	25"	33"	24"	12"	20"	26"	22"	119
6	32"	25"	30"	12"	12"	18"	28"	124
7	32"	33"	30"	12"	20"	26"	28"	139

ADD MOTOR AND OPTION WEIGHTS

9000 SERIES EXHAUST REEL FOR CARBON MONOXIDE FUME

MAINTAIN SAFE AIR QUALITY IN THE WORK SPACE

Exhaust reel for safe and efficient storage of hose used to extract carbon monoxide fumes from vehicle exhaust at indoor work places. Two hose sizes at 25 foot lengths. Automatic spring rewind with a lock out mechanism to hold hose out at the working length. Wall, ceiling or floor mounting. Powder coat finish in red.

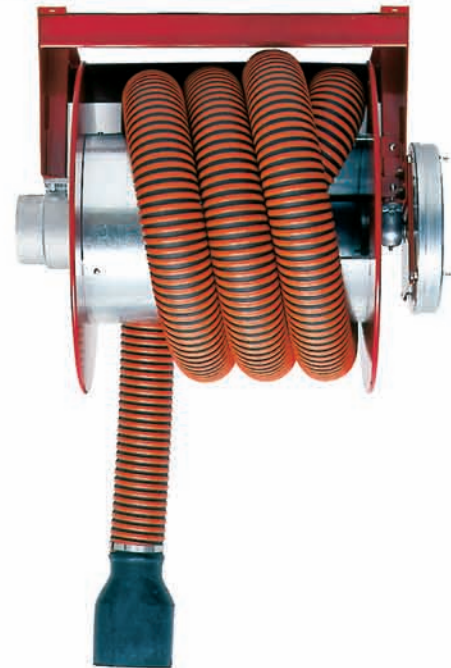

SERIES 9000 EXHAUST REELS

Model Number	Description	Shipping Weight
9000	Exhaust Reel Less Hose 4"	78 lbs.
9001	Exhaust Reel Less Hose 5"	82 lbs.
9004	Exhaust Reel with 4" Hose	96 lbs.
9005	Exhaust Reel with 5" Hose	100 lbs.

DIMENSION CHART

Model	Diameter	Height	Width
9000	24"	26"	31"
9001	30"	32"	31"
9004	24"	26"	31"
9005	30"	32"	31"

WELDING CYLINDER TRUCKS WITH RETRACTABLE WELDING REEL

This sturdy tubular welding truck with a Bi-Line oxygen and acetylene hose reel will solve a lot of hose problems. A built on hose reel retracts hose back onto the cart, protects hose and saves much handling time. Eliminates messy hoses strung over hand cart and tanks. Comes with hook up lines to tanks.

Model PW-23 **Width 32"** **Height 43"**

For large oxygen and acetylene cylinders with a combined diameter of not more than 23 inches. Twelve inch ball bearing wheels with tool tray. Finished in powder coat red.

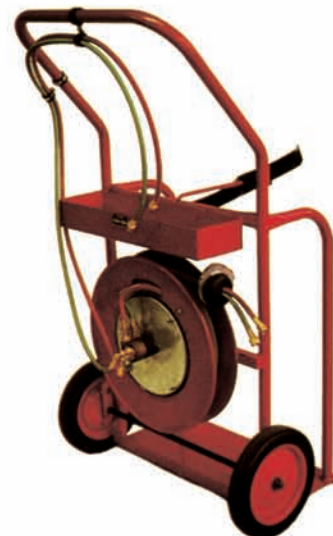

F.O.B. Factory

CEILING MOUNT ENCLOSURES

FOR INDIVIDUAL OR MULTIPLE BANK ENCLOSURES

- Easily bolted together for a smooth clean look.
- Nylon rollers in aluminum frame guides hose freely.
- Hose reels slide into place and secure with one bolt.
 - No assembly of reel enclosures.
- Hook up lines furnished with each reel.
- Metal enclosures finished in a white powder coat finish with white or black end panels.

For use with standard 1400, heavy duty 1200, 1300 or 2500 series reels.

Model	Description	Shipping Weight
19-1	REEL HOUSING (Cabinet) One for each hose reel.	45
19-2	END PANELS (Set) One set for single or multiple banks.	7
MC-1	I BEAM MOUNT CHANNEL Two for mounting single. One for every cabinet in reel bank.	5



* Consult factory for other available colors.

19-1 REEL HOUSING

DIMENSION CHART				
A	B	C	D	E
17"	13 1/2"	25"	25"	21"

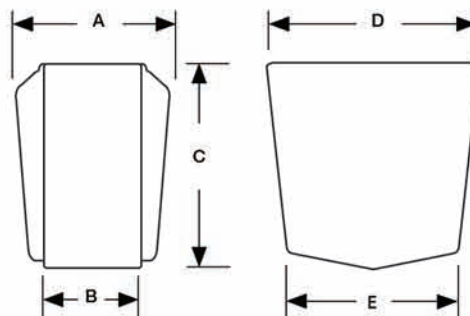

F.O.B. Factory
(For mounting plates see page 24)

ENCLOSURES

FIBERGLASS

ONE PIECE DURABLE FIBERGLASS CONSTRUCTION

Enhances appearance while giving protection of hose reel. One piece construction for rigidity. Finished in permanent smooth white. Entire cover is easily removed by means of accessible fasteners. Aluminum and nylon roller hose outlet for best hose wear. Enclosures may be purchased separately for use with previously installed hose reels or competitive models.

When ordered with hose reel the unit is shipped completely assembled.

Overhead installations are made easy by means of a slide plate. Plate is secured first then complete unit is slid into place. After connecting the inlet source line the unit is ready to use.

No pre-assembly of enclosure or mounting of hose reels is required.



HOW TO ORDER

First pick out desired hose reel, then order corresponding enclosure from chart below. State mounting position, ceiling, floor or wall. Consult factory for other available colors.

Enclosure Type	Reel Type	Width	ENCLOSURE DIMENSIONS		Shipping Weight
			Length	Height	
1	1400 all models	11"	21 1/2"	19 1/2"	30 lbs.
2	1200, 1300, all models	11"	24 1/2"	24"	40 lbs.
3	Combination of two 1200, 1300 or 1400 and 3001 thru 3011	22"	28"	30"	55 lbs.
4	Custom Painted Steel	————	Specify Reel	————	N/A
5	Custom Stainless Steel	————	Specify Reel	————	N/A

F.O.B. Factory

MULTIPLE MOUNTING PLATES

FOR DURO REELS



MC-1 I BEAM MOUNTING CHANNEL

Fits all I beams to 8". Installs directly on all mounting plates listed below. Installs directly to the base of 1200, 1300, 2100, 1800 H.D. and all 1900 enclosures. Two required for a single open reel.

19-1 BANK ENCLOSURES

SPECIAL I BEAM ENCLOSURE PLATES

Model Number	Description
EP-1	ONE ENCLOSURE
EP-2	TWO ENCLOSURES
EP-3	THREE ENCLOSURES
EP-4	FOUR ENCLOSURES
EP-5	FIVE ENCLOSURES
EP-6	SIX ENCLOSURES

For more than six enclosures use combination of plates.

NOTE:

The (EP) plates listed above come with the (MC) I beam channel welded to them.



The listed mounting plates are for installing Duro Reels to wall or ceiling (steel) with bolts, weld or I beam channels.

1400, 1600, 1800 SERIES

Model Number	Description
MP-1	ONE REEL (1400, 1600, 1800 REG.) (Two I beam channels must be used)
MP-2	TWO REELS (1400, 1600, 1800 REG.) (Two I beam channels must be used)
MP-3	THREE REELS (1400, 1600, 1800 REG.) (Three I beam channels should be used)
MP-4	FOUR REELS (1400, 1600, 1800 REG.) (Three I beam channels should be used)

For more than four reels use combinations such as MP-2 and MP-4 for six reels or two MP-3.

1500, 1700 SERIES

Model Number	Description
MP-5	ONE DOUBLE REEL (1500, 1700) (Two I beam channels must be used)
MP-6	TWO DOUBLE REELS (1500, 1700) (Three I beam channels should be used)
MP-7	THREE REELS (1500, 1700) (Four I beam channels should be used)

For more than three double reels (6 Reels) use combinations.

1200, 1300, 2100, 1800 & 2500 HD SERIES

Model Number	Description
MP-8	ONE REEL (1200, 1300, 2100, 1800HD) (Two I beam channels must be used)
MP-9	TWO REELS (1200, 1300, 2100, 1800HD) (Three I beam channels must be used)
MP-10	THREE REELS (1200, 1300, 2100, 1800HD) (Four I beam channels must be used)
MP-11	THREE REELS (1400 or 2500 COMBINED) (Four I beam channels must be used)
MP-12	THREE REELS (1200, 1300, 2100, 1800HD, 2500) (Four I beam channels must be used)

For more than three reels use combinations.



DISPLAY RACK MODEL DR2006

DURO HOSE REEL DISPLAY RACK CONSTRUCTED OF HEAVY GAUGE STEEL & 1-1/2" SQUARE TUBING WILL FEATURE UP TO FOUR REELS AND ALSO INCLUDES A FULL COLOR 34" X 22" POSTER. ALLOW YOUR CUSTOMERS TO SEE AND FEEL DURO'S OUTSTANDING DESIGN AND QUALITY FEATURES AND INCREASE YOUR HOSE REEL SALES.
ALL HARDWARE INCLUDED.

**CALL NOW TO SEE HOW YOU CAN GET YOUR
FREE DISPLAY RACK!
1-800-866-DURO**



Quality crafted in the U.S.A.

DIMENSIONS: 32"W X 90"H X 30"L

OTHER DURO PRODUCTS

SELF SERVICE AIR & WATER FOR SERVICE STATIONS



WALL MOUNT



MODULE



COMPRESSOR UNITS



GRAVITY RETRACTORS

WARRANTY

WARRANTY: Hose reels and component parts manufactured by Duro Mfg. Inc. are guaranteed to be free from defects in material and workmanship for a period of one (1) year from date of invoice.

WARRANTY: Rubber hose not of our manufacture is guaranteed as per original manufacturers' warranty program. Rubber hose is guaranteed to be free from defects at the time it is put to use or reasonable notification of 30 days.

WARRANTY: Other related products sold by Duro Mfg. Inc. not of our manufacturing will be guaranteed in line with OEM warranty.

In any case, parts or units found to be defective by reason of faulty material or workmanship will be replaced at no charge, after inspection by our factory. Duro Mfg. Inc. liability shall be limited to the repair or replacement only. Maximum liability is in no case to exceed the value of Duro unit involved. No returns or charges will be accepted without prior agreement with the factory. This warranty becomes void if equipment has been tampered with or misused in other than intended design function. No responsibility will be assumed for improper choice of models, installation or varied uncontrollable field conditions. We reserve the right to make engineering changes in material and in dimensions for improving the performance of our equipment.

TERMS AND CONDITIONS

TERMS: Net 30 days on approved credit, (Visa, MasterCard accepted).

Minimum billing \$15.00

A service charge of 1 1/2% on past due accounts to cover cost of extra accounting.

FREIGHT: F.O.B. Factory.

Our responsibility ends at the acceptance of material by the common carrier.

Consignee must file claim for shortages and damaged freight against common carrier if it occurs.

RETURNS: Material returned for credit is subject to a prior notification and a 15% handling restocking fee. Materials returned for credit not resaleable are subject to a rebuilding fee. All returns must be freight prepaid unless prior arrangements are made.

CANCELLATION FEE: A charge will be made on any order cancellation after shipment has been made or any special order for materials not of our stock.

QUOTATIONS: All quotations are for immediate acceptance and are subject to any fluctuation in increased cost of materials after 30 days.

SPEC. DESIGNS: Non standard products to customer's specifications can be canceled on written notice, but are subject to all expenses incurred at that time. Special designs to customer's specification are not returnable.

BUSINESS HOURS: 7:30 AM - 4:00 PM (PST)



Quality crafted in the U.S.A.

DISTRIBUTED BY:

DURO MANUFACTURING INC.

3505 Arrowhead Drive • Carson City, Nevada 89706

(775) 687-8866 • FAX: (775) 687-8877

www.durohosereels.com

Printed in U.S.A.
Catalog A-08